

two-way valves with seal, symmetrical

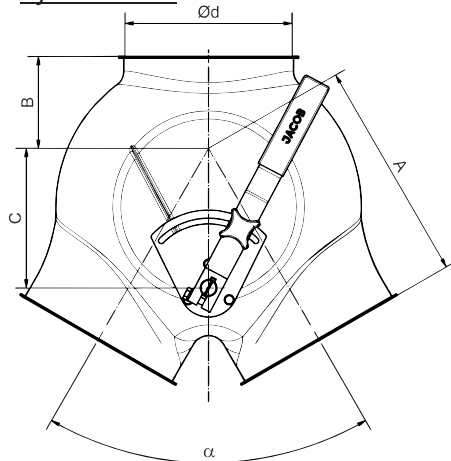

two-way valves with seal, asymmetrical

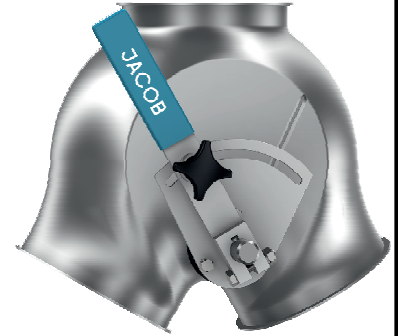
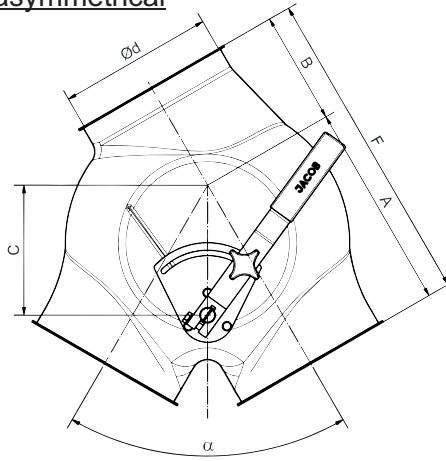

All-round flap seal
quality NBR
suitable for food
oil resistant
temperature resistant up to +80°C

Installation position:

In the bulk area according to the flow behavior of the products used

Applications:

For gravity conveying of free-flowing bulk goods and in ventilation plants up to 0.1 bar. There is no seal underneath the shaft, so that in the case of higher tightness requirements towards the closed outlet the two-way distributor should be used.

Standard double-sided shaft seal with double V-ring quality NBR

Special shaft with ball bearings on both sides and with an O-Ring with a Viton seal (specify when ordering)

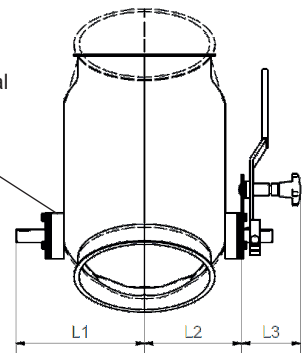

Pipe diameter tolerance and roundness tolerance to DIN EN 10296-1
Lengths and angles – DIN ISO 2768-1 – Tolerance class V

* 1=powder-coated, 3=stainless steel

Pipe		Ø 100	Ø 120	Ø 150		Ø 175		Ø 200	
symmetrical version	Articel-no.	1210*503	1212*503	1215*503	13151503	1217*503	13171503	1220*503	13201503
	A	135	160	200		218		265	
	B	50	50	80		63		110	
	C	87	112	136		170		167	
asymmetrische version	Articel-no.	1210*513	1212*513	1215*513	13151513	1217*513	13171513	1220*513	13201513
	A	135	160	200		218		265	
	B	65	70	100		90		145	
	C	87	112	136		170		167	
F	200	230	300		308		410		
α	60°	60°	60°		60°		60°		
Ø d	99	119	149	148	174	173	199	198	
S	2	2	2	3	2	3	2	3	
L1	140	148	168		198		199		
L2	88	96	119		149		150		
L3	88	88	88		88		88		
Pipe		Ø 250		Ø 300		Ø		Ø	
symmetrical version	Articel-no.	1225*503	13251503	1230*503	13301503	-	-	-	-
	A	305		385		-	-	-	-
	B	115		145		-	-	-	-
	C	215		260		-	-	-	-
asymmetrische version	Articel-no.	1225*513	13251513	1230*513	13301513	-	-	-	-
	A	305		385		-	-	-	-
	B	155		190		-	-	-	-
	C	215		260		-	-	-	-
F	460		575		-	-	-	-	
α	60°		60°		-	-	-	-	
Ø d	249	248	299	298	-	-	-	-	
S	2	3	2	3	-	-	-	-	
L1	220		264		-	-	-	-	
L2	171		197		-	-	-	-	
L3	88		88		-	-	-	-	

Denomination:

two-way valves with seal
hand-operated

Date: 04/20

Datasheet-no. 9/9

Rev. 0