

Pull ring profile

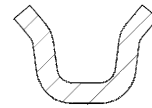

* 2=galvanized, 3=stainless steel

Explosion pressure shock resistance (possible up to DN 315):
 required screw torque Ma = 25Nm

Pull ring for 1 and 2 mm wall thickness

Pipe	Ø 60	Ø 80	Ø 100	Ø 120	Ø 140	Ø 150	Ø 160	Ø 175
Articel-no.	1206*383	1208*383	1210*383	1212*383	1214*383	1215*383	1216*383	1217*383
Ø B	60	80	104	124	140	154	158	179
Ø A	81	101	125	145	161	175	177	200
Weight in kg	0,3	0,31	0,33	0,36	0,37	0,39	0,4	0,42
Pipe	Ø 200	Ø 224	Ø 250	Ø 280	Ø 300	Ø 315	Ø 350	Ø 400
Articel-no.	1220*383	1222*383	1225*383	1228*383	1230*383	1231*383	1235*383	1240*383
Ø B	204	224	254	281	304	316	354	404
Ø A	225	245	275	302	325	337	375	425
Weight in kg	0,45	0,47	0,51	0,55	0,57	0,59	0,63	0,68
Pipe	Ø 450	Ø 500	Ø 560	Ø 630	Ø	Ø	Ø	Ø
Articel-no.	1245*383	1250*383	1256*383	1263*383	-	-	-	-
Ø B	450	500	560	632	-	-	-	-
Ø A	478	524	586	656	-	-	-	-
Weight in kg	0,73	0,78	0,83	0,90	-	-	-	-

Pull ring for 3 mm wall thickness

Pipe	Ø 120	Ø 150	Ø 175	Ø 200	Ø 250	Ø 300	Ø 350	Ø 400
Articel-no.	1212*926	1215*926	1217*926	1220*926	1225*926	1230*926	1235*926	1240*926
Ø B	126	156	181	206	256	306	356	406
Ø A	151	181	206	231	281	331	381	431
Weight in kg	0,36	0,39	0,42	0,45	0,51	0,57	0,63	0,68

Denomination:

Pull-rings without sealant

Date: 07/24

Datasheet-no. 2/2

Rev. 2